

Yacht Isabela II

Galápagos Islands



Cruise Expedition

An outstanding vessel for a close-up and personal expedition to the Galapagos. A private yacht where the islands' intimacy is felt in every way.

Facilities

- Bar - Lounge, Boutique
- Gift Shop
- E-mail, radio, telephone and fax communications
- PA System
- Snorkeling Equipment
- Stargazing Program
- Glass bottom boat
- Jacuzzi
- Reading Room and Natural History Library
- Air conditioned throughout



Cabin Type 1



Bar & Lounge



Library & Reading Room



Cabin Type 3



Jacuzzi



Dining Room

Extraordinary Expedition from



Deck Plans

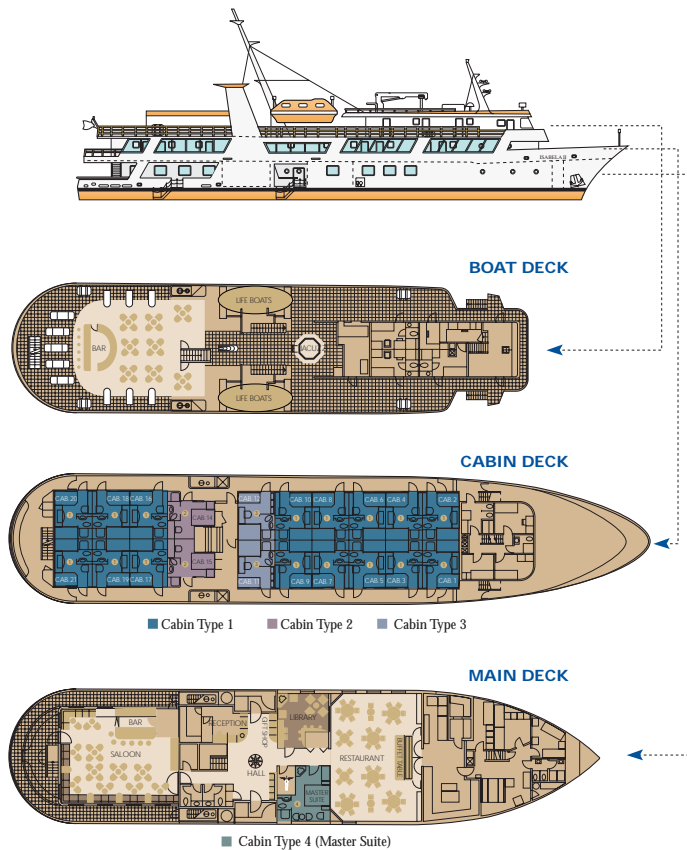

Technical Specifications

Year of Construction:	1979
Reconstruction:	Pensacola, Florida, 1988
Refurbishment:	Panama, March 2000
Category:	Deluxe Expedition Yacht
Gross Tonnage:	1.025 tons.
Type of Vessel:	Motor Yacht
Capacity:	40 guests
Length:	53.72 meters (166 feet)
Beam:	11.58 meters (38 feet)
Speed:	10 knots
Electricity:	110 Volts 60 Hz.
Engines:	2 GM Detroit Diesel 900 BHP each
Navigation Equipment:	Gyrocompass, Automatic Pilot, radar, and GPS
Safety Classification:	SOLAS 74 - ISM
Fire Detector:	Automatic with control from the bridge.
Life Jackets:	In each cabin
Life Boats:	2 units semi enclosed
Life Rafts:	Two 16-man, two 10-man
Zodiacs:	3 for ship to shore transportation
Boston Whaler:	1 with glass- bottom for underwater observation
Owner:	ETICA (Metropolitan Touring)
Decks:	3 (Boat deck, Cabin deck, Main deck)
Crew:	24
Naturalist Guides:	3 (includes Expedition Manager)
Medical Officer:	Permanently on board

Cabin Distribution

The yacht has 21 cabins,
20 in the cabin deck and one in the main deck

- 16 cabins with twin beds.
- 2 cabins with double bed for single or double use.
- 2 cabins with double bed plus a single bed for double or triple (child) use.
- 1 suite with double bed.

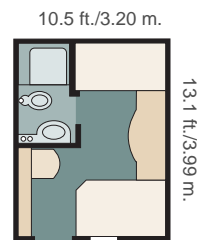

Cabin Type 1
12.80 m² // 139 sq. ft.

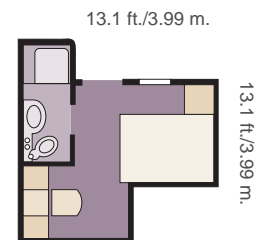

Cabin Type 2
12.05 m² / 128 sq. ft.

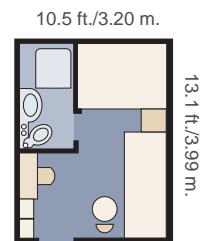

Cabin Type 3
12.80 m² / 139 sq. ft.

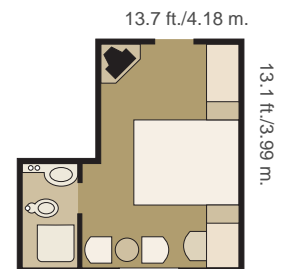

**Cabin Type 4
Master Suite**
18.90 m² / 170 sq. ft.

